



AcryLux

We take care of your smile



3D View
dentin/neck



3D View
enamel/neck



3D section of
stratification



3 LAYERS OF ACRYLIC

**NEW LOW
PRICE**

- Ultimate value three-layer tooth
- 20 degree cusp angle – geometric style
- 25-33 degree cusp angle – anatomical style

NOW ONLY

\$10⁵⁰

PER CARD!



Miratray® Implant Advanced

Implant impression tray with patented foil technique



- Saves you and your patient an additional visit and laboratory cost
- Controllable and safe impression taking with clear view of implant posts
- Clean impression is taken as foil meets precisely at implant posts
- No overflowing impression material
- Customisable, user-friendly and cost-effective
- Available in three sizes for maxilla and mandible (dentulous and edentulous)
- Suitable for all implant impression materials and implant systems

#101250

\$78⁹⁵

Intro Kit (6)
One of Each Size
(small, medium & large)



<https://youtu.be/ZUm9C8wZBhI>

visio.lign neo.lign



NATURALLY BEAUTIFUL TEETH

The development of visio.lign was based on natural teeth. The vivid and lifelike design of the veneers was transferred to the neo.lign denture teeth. neo.lign anterior and posterior are the logical supplements to the visio.lign veneering system as far as shade, shape and layer design are concerned and are suitable for partial dentures, attachment restorations and implant prosthetics.

- Vivid Designs
- Functional Concepts
- Individual esthetics Ideal for combined restorations



bredent group

What you see is what you get!

MALC15 Lighted Work Chamber

MALC15 Lighted Work Chamber keeps dust and debris contained when grinding, sanding, polishing and drilling workpieces that fit in your hand. The compact, semi-enclosed unit is designed for use with compressed air and dust collection. The compressed air blows the dust to the back of the unit where the suction is the strongest. It is a great addition to the benches of jewelers, dental and other lab technicians, carvers, and custom fabricators working with small workpieces.



\$540⁰⁰

#MALC15

QUATRO
AIR TECHNOLOGIES INC.
ENGINEERS OF CLEAN AIR

SMART VAC +

- Fully automatic, self-activating Filter Cleaning System (FCS) with "No-Touch" Filter Cleaning.
- True HEPA Filter, 99.97% efficiency on sub-micron particles
- Hybrid INFINITY motors provide prolonged motor life
- Built-in extra-large collector
- Silent operation, quietest units on the market (50-55dbA)
- Separate access doors allow debris removal without having to access filter section.
- Remote Switch (AA375) Included



Extended Service Life
NEW INFINITY MOTORS

	Users	PN	Voltage	H x W x L, Weight	Speed	Debris Storage	HEPA INCLUDED	
SmartVAC	⁽¹⁾ 1-2	iVL-31116-D2	120V	22x15x20", 65 lbs	Variable	up to 4 gal	HEPA INCLUDED	\$1255⁰⁰ Reg.\$1395
		iVL-31126-C2	230V	(56x38x51cm, 29.5 kg)	Variable	up to 15l		
SmartVAC TWIN	⁽²⁾ 1-4	iVTL-32116-D4	120V	29x15x20", 85 lbs	Variable	up to 7 gal	HEPA INCLUDED	\$1795⁰⁰ Reg.\$1995
		iVTL-32126-C4	230V	(74x38x51cm, 38.5 kg)	Variable	up to 26l		
SmartVAC mc ²	⁽³⁾ 1-2	iVL-21116-D2	120V	22x15x20", 65 lbs	Variable	up to 4 gal	HEPA INCLUDED	\$1327⁰⁰ Reg.\$1474



LUCITONE FRS

4+1

MIX & MATCH



AQUASIL ULTRA

2+1

DENTSPLY

CENTRAL DENTAL INSTRUMENTS



These high quality Dental Instruments are essential to every day lab-use. Take advantage of our great prices and stock up on these great essential Instruments in your Lab.



\$19⁹⁵

PLIERS 2-PRONG
CDP-2

\$19⁹⁵

PLIERS 3-PRONG
CDP-3

\$7⁹⁵

LARGE
FAHNSTOCK
CDK-F

\$7⁹⁵

KNIFE 7R
CDK-7R

\$7⁹⁵

KNIFE 6R
CDK-6R

\$5⁹⁵

BLADE
HANDLE #3
CDH-3

ivoclar
vivadent

3+1

Impression Materials Specials

Virtual® XD Impression Materials
Virtual® Impression Materials

[Same delivery form as purchased item. Mix and match viscosities.]



Purchase \$2,000
of Virtual® XD / Virtual®
Impression Materials
& Receive a FREE
Virtual Mixer!

**\$2084
VALUE**



655988
Virtual Mixer

For better dentistry

DENTSPLY
CANADA

**PURCHASE A LUCITONE 199 5LBS
TUB (Special Price of \$299.00)
and Receive FREE LIQUID!**



FREE LIQUID: Includes
2 Bottles of Lucitone Lab
Liquid for 430ml #684309 &
L199 Shade Guide #89729

INITIAL IQ LP NF

GC Initial IQ Lustre Pastes NF

are 3-dimensional ceramic pastes developed to create color depth and life-like translucency with a single paint on application. Thanks to the "New Formula" (NF), you can really bring your crowns and bridges to life with this dedicated Lustre Paste Set, an optimal match to both "low" and "high" CTE ceramics.



4+1

BUY 4 INITIAL IQ LP NF REFILLS, GET 1 INITIAL IQ LP NF FREE!

GC INITIAL LiSi

This ceramic is the specialized veneering ceramic designed for **Lithium Disilicate** frameworks. With this type of frameworks gaining popularity, GC offers now a material for highly aesthetic and durable restorations for long-term patient satisfaction. Thanks to the exactly cross-matched coefficients of thermal expansion (CTE), its low firing temperature and highest stability during multiple firings, GC Initial LiSi ensures you a safe and predictable processing of Lithium Disilicate frameworks.



3+1

BUY 3 GC INITIAL LiSi REFILLS GET 1 FREE!

\$44⁹⁸

20g Bottle

ZIRCONIA DISC HT



#878118
(98mm x 12mm)

2+1

BUY 2 INITIAL ZIRCONIA DISC GET 1 INITIAL ZIRCONIA DISC FREE!

Reg. **\$219⁹⁷** Net Price of **\$146.65** when including FREE Goods!

OPTIGLAZE Colour Set

A light-cured characterization coating designed for composite and acrylic indirect restorations. Optiglaze color is a revolutionary new material developed specifically to stain and glaze your cerasmart milled blocks, composite, acrylic, and pmma type materials. You can now change shades, shift value, characterize, create effects and glaze all your resin type prosthetics in no time at all. Best of all, offer your dentists and patients a more beautiful and aesthetic restoration that will last due to gc's innovative new homogeneously dispersed nano filler technology.

BUY 1 OPTIGLAZE Colour Set, GET 1 OPTIGLAZE Coating 15ml bottle FREE!

\$75⁰⁰ VALUE



\$699⁰⁰

#47001

Optiglaze Coating simplifies the finishing process by providing an aesthetic glossy surface on artificial teeth, removable dentures, temporary crowns and individual acrylic trays. GC Optiglaze is the solution for difficult to polish areas such as posterior fissures or interproximal areas of indirect composite restorations.

FUJIROCK EP



BUY 3 of ANY FUJIROCK EP (Any size and colour) GET 1 FREE!

3+1

NATURE-CRYL



Free Liquid!

BUY ANY NATURE-CRYL ACRYLICS (Any size) GET CORRESPONDING LIQUID FREE!

Buy 5
Get 1
FREE!

DIATIT TUNGSTEN CARBIDE BURS

Smooth
Running
& Longer
Lasting

Diatit tools feature the advanced Diatit wear protection coating. This is a special material which is added into the surface of the bur after it has been produced. It hardens the tool surface and reduces the surface friction. Results in a smoother running and longer lasting bur.



Material	Tungsten carbide	Diatit
REF	D200 KG 23	\$28⁹⁵
ISO-No.	509 104 200220 023	



D200 KG 23 for finishing of CoCr frameworks.

Application field	Plaster	Denture resin	Veneer resin	Precious metal/pd-based	CoCr denture/NPM	Ceramic
Working speed rpm	10-20,000	8-12,000	10-17,000	15-20,000	15-20,000	15-20,000



Material	Tungsten carbide	Diatit
REF	D237 KG 65	\$48⁵⁰
ISO-No.	509 104 237220 065	



D237 KG 65 excellent removal of material and smooth running for efficient processing of resin.

Application field	Plaster	Denture resin	Veneer resin	Precious metal/pd-based	CoCr denture/NPM	Ceramic
Working speed rpm	10-20,000	8-12,000	10-17,000	15-20,000	15-20,000	15-20,000



Material	Tungsten carbide	Diatit
REF	D263 KG 60	\$50⁹⁵
ISO-No.	509 104 263220 060	



Due to its shape and the coarse cut the D263 KG 60 is well suited for grinding of plaster dies..

Application field	Plaster	Denture resin	Veneer resin	Precious metal/pd-based	CoCr denture/NPM	Ceramic
Working speed rpm	10-20,000	8-12,000	10-17,000	15-20,000	15-20,000	15-20,000



Material	Tungsten carbide	Diatit
REF	D274 KG 60	\$53²⁵
ISO-No.	509 104 274200 060	



The D274 KG 60 is suitable for all materials due to this coarse cut.

Application field	Plaster	Denture resin	Veneer resin	Precious metal/pd-based	CoCr denture/NPM	Ceramic
Working speed rpm	10-20,000	8-12,000	10-17,000	15-20,000	15-20,000	15-20,000



Material	Tungsten carbide	Diatit
REF	D292 KG 23	\$28⁹⁵
ISO-No.	509 104 292220 023	

Application field	Plaster	Denture resin	Veneer resin	Precious metal/pd-based	CoCr denture/NPM	Ceramic
Working speed rpm	10-20,000	8-12,000	10-17,000	15-20,000	15-20,000	15-20,000



Material	Tungsten carbide	Diatit
REF	D194 KG 23	\$27⁶⁰
ISO-No.	509 104 194220 023	



D194 KG 23 for efficient CoCr processing

REF	D194 KG 40	\$39⁹⁵
ISO-No.	509 104 194220 040	

REF	D194 KG 50	\$49⁹⁵
ISO-No.	509 104 194220 050	



The coarse cuts of the D194 KG 40 (picture 3) and the D194 KG 50 (picture 2) guarantee fast and perfect finishing of resin.

TRANSFUSER

Gentle and safe transfer of investment and gypsum.

SPECIAL

\$23⁹⁵

Reg. \$33.95

390S0001



GIFLEX DIAMOND DISC

Features diamond-coating on both sides and is particularly suitable for cutting plaster and resin dies.

SPECIAL REGULAR

34000025 (25mm)	\$41⁵⁰	\$53.50
34000120 (30mm)	\$47⁰⁰	\$62.00
34000020 (37mm)	\$52⁰⁰	\$67.00
34000110 (45mm)	\$58⁰⁰	\$75.00

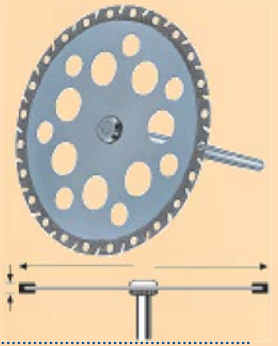

EXAKTO-FORM

Model resin for accurate reproduction and maximum edge stability in five different colors.

SPECIAL

\$86⁰⁰ SAVE \$24.00

Reg. \$110.00



Component A+B (6 x 50 g)

Grey 520 0028 3
 Yellow 520 0028 4
 Ivory 520 0028 2
 Olive Green 520 0028 0
 Blue 520 0028 1

PI-KU-PLAST HP 36

Exceptional material properties such as perfect contouring characteristics and no slumping provide the precondition for top-quality casting results.

Colours Available:

Transparent 54000216
 Yellow 54000217
 Orange 54000218
 Blue 54000219
 Red 54000220

SPECIAL

\$219⁹⁵ SAVE \$40.00

Reg. \$259.95



SET-UP-TOOL

34001010

Two grinding tools in one. Occlusal & Basal.

SPECIAL

\$62⁴⁰

SAVE \$27.00

Reg. \$89.40

OCCUSAL



BASAL



VKS-SG Matrices 1.7mm
 Red, Yellow or Green
 Pkg (8)



SPECIAL

\$48⁰⁰

SAVE \$20.00

Reg. \$68.00

COMPOFORM UV

Light-curing composite for modelling, fixation of separated bridges and for quick fabrication of post and core restorations.

SPECIAL

\$84⁰⁰

SAVE \$35.00

Reg. \$119.00

2 x 3 ml syringes
 10 application cannulas
 540 0115 0



QU-RESIN

Quick-setting, self-curing denture repair resin based on diacrylate for intraoral and extraoral (direct and indirect) use.



KIT SPECIAL 54001161

\$119⁰⁰ SAVE \$30.00

Reg. \$149.00

REFILL SPECIAL 54001165

\$99⁰⁰ SAVE \$20.00

Reg. \$119.00

TECHNICAL CORNER

Diamond D Microwave Denture Processing Technique - New Flask

- 1) Vaseline the inside of flask.
- 2) Invest model in lower half of flask using a half and half mixture of plaster and stone or all stone (Type III recommended).
- 3) After gypsum sets, paint plaster and stone separator or Vaseline on gypsum.
- 4) Put top section of flask into place. Vibrate and pour half and half mixture of gypsum or all stone into flask (Type III stone or flasking stone recommended).

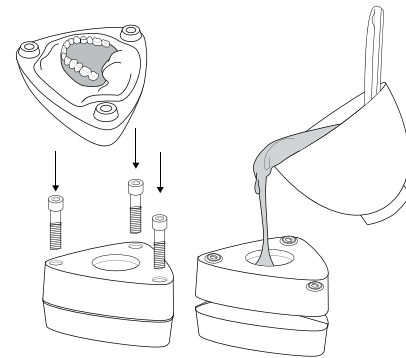

- 5) After gypsum is set, place flask into a variable stage 500-700 watt microwave for 60 seconds. Adjust wattage to 500 watts.
- 6) Open flask and remove bulk of wax. Boil out all surfaces with clean boiling water and then use detergent or Diamond D Ultra Wash solution to ensure all wax is removed from gypsum and teeth. Then rinse again with clean boiling water.
- 7) After steam stops rising from flask paint on first coat of Diamond D Ultra Sep Separator. When first coat dries, apply second coat.

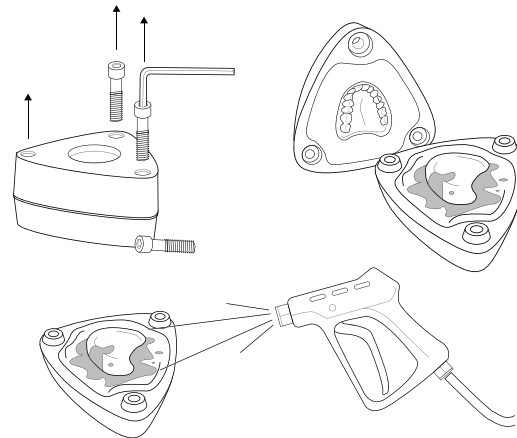

- 8) Mix 30ml of Diamond D Acrylic to 10ml 20-minute monomer (P/L ratio by volume).
- 9) Start trial packing procedure before acrylic gets to a snap stage and the acrylic is easy to handle.

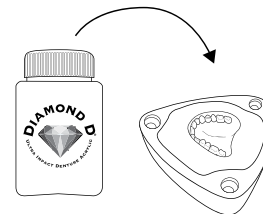

- 10) After trial packing denture, close flask, tighten screws and let bench set for 5 minutes.

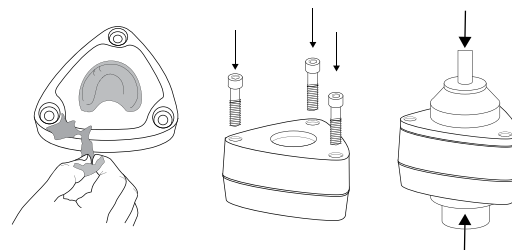

- 11) Place flask in microwave oven and adjust microwave to 100 watts and cure for 8 minutes.
- 12) After 8 minutes, adjust microwave to 500 watts and cure an additional 2 minutes.
- 13) Bench cool for 15 minutes and then place in cool water for 10 minutes.

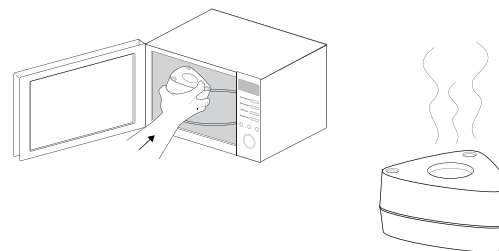

- 14) Deflask denture and finish.

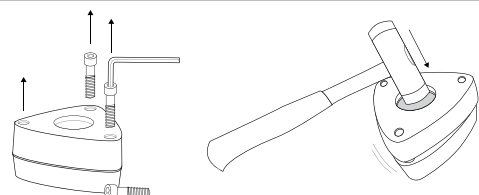

Tecnoflask

MICROWAVEABLE FLASK

Keystone Industries could not be more excited for a product that helps develop excellent Diamond D® and other acrylics in much quicker time, and easier fashion. The TF-100 muffle will give your laboratory a cleaner environment and make the process more enjoyable for the production of your work.

\$236

#1009200



- Acrylic material designed for use in microwave
- Cannot be damaged by exertion of pressure
- Polymerization time shortened to four minutes
- Used in the making of total upper and lower dental prostheses
- No isolating material needed between the muffle and the plaster

- Does not require a specific resin
- Increased removal of residual monomer
- Reduction in energy consumption
- Cleaner and faster than the traditional
- High quality denture

**BUY 1 FLASK AND RECEIVE
1lb. DIAMOND D KIT FREE!**



Diamond D DENTURE ACRYLIC

- Handling and finishing properties are second to none
- High tooth to base adhesion
- Dead on shade matches to industry standards
- Exceptional flexural strength and impact resistance
- Smooth packing consistency
- Better fit

Shades:

- Original
- Light-Reddish Pink
- Dark Veined
- Chroma Essence

INTRODUCING

AccuDent® XD

Alginate Impression System

ivoclar
vivadent®
passion vision innovation



A beautiful smile makes
a great impression...

...but it takes a great impression to make a beautiful smile.

*Introducing AccuDent XD, the next generation
alginate impression System.*

- **Dual-phase alginate materials** for more accuracy and precision than traditional alginates
- **Thermoplastic heat moldable impression trays** to accommodate all arch forms
- **Low cost and fast set time** for optimum productivity

**BUY 1 ACCUDENT XD TRIAL KIT
GET 1 (12pk) OF ACCUDENT XD TRAYS FREE!**

\$41.00
VALUE

#680375 Accudent XD EDENTULOUS Trial Kit \$165

#680376 Accudent XD DENTATE Trial Kit \$165

cubeX² cubic zirconia



THE NEXT EVOLUTION OF ZIRCONIA

CubeX2 - Beauty and strength together at last

CubeX2 combines the known positive properties of zirconia with a significant increase in translucency (49% translucency), making it ideal for monolithic anterior and posterior applications up to 3-unit bridgework in all tooth positions. CubeX2 has the translucency of a lithium disilicate while retaining the strength of zirconia (720 MPa's).

- 80% greater flexural strength than lithium disilicate - 720MPa versus 400MPa
- 49% greater translucency than regular zirconia - 49% versus 30%
- Less aggressive tooth preparation required compared to lithium disilicate system, saving tooth structure and supporting more conservative treatment.

Offer your customers a highly esthetic, durable and patient-friendly premium solution that separates you from your competition.

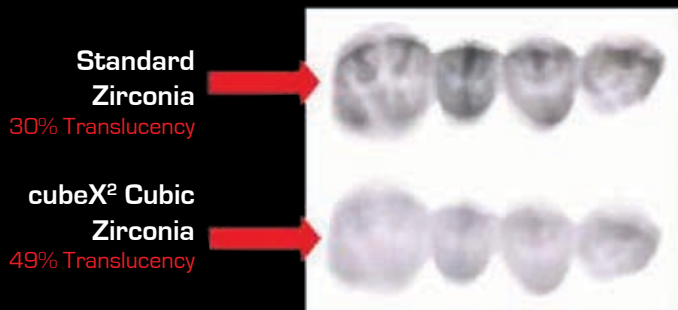

cubeX² has the translucency of lithium disilicate



Lithium Disilicate

cubeX²

Available for purchase in 98.5mm discs:

Size	Price	Approximate unit cost (based on 20 units per disc)
98.5mm x 10mm	\$200	\$10.00
98.5mm x 12 mm	\$217	\$10.85
98.5mm x 14mm	\$233	\$11.65
98.5mm x 16mm	\$250	\$12.50
98.5mm x 18mm	\$267	\$13.35
98.5mm x 20mm	\$283	\$14.15
98.5mm x 25mm	\$317	\$15.85

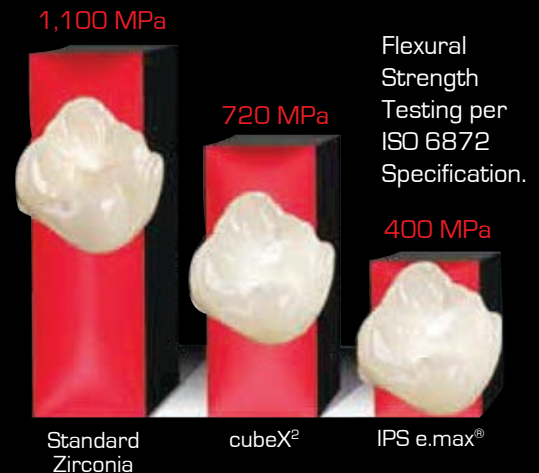

Cubex2 is also available as an outsourced product through Core3d Milling Centres.
For more info, to order or to inquire about getting CubeX milled for you by Core3d Milling Centres call: 1(800)268-4442



COURSES & EVENTS

Jan. 30th - DTA - Central Dental - Toronto

Feb. 6th - DISC - Central Dental - Toronto

Feb. 25 - 27th - Mid-Winter - Chicago

March 5th - DISC - Central Dental - Toronto

March 11th - GC - Central Dental - Toronto

"The Art of Pack Pressing, Processing, Coloring and Finishing"

March 19th - DTABC - 34th Annual Conference - Vancouver

April 2 - DTA - Central Dental - Toronto

April 8 - 9th - Technorama - Hilton Suites - Markham

April 15 - 16th - Spectrum Day Edmonton

April 23 - DISC - Central Dental - Toronto

May 6 - 7th - Core 3D Academy - Central Dental - Toronto

"3 Shape Software Training"

May 14th - DTA - Central Dental - Toronto

May 21 - DISC - Henry Schein - Concord

June 17th - PYP - Guelph

Sept. 10th - DTA - Central Dental - Toronto

Sept. 15 - 17th - Expodent 2016 - Quebec City

Sept. 17th - Spectrum Day - Vancouver

Sept. 24th - DISC - Henry Schein - Concord

For more info visit our website: www.centraldentaltd.com
or call us at: **1 (800) 268-4442**